

# BOLLARD

• WAREHOUSE •

DESIGNED, TESTED & MANUFACTURED IN THE U.S.A.



## CHILDCARE

High security pedestrian  
protection for schools,  
libraries, and daycares.



ASTM INTERNATIONAL



Scan for more info

### TECHNICAL SPECS

#### 10 MPH Removable Bollard 5" (CIR HL2005 S10)

- Core-In ASTM F3016 S10 (10MPH) crash tested bollard system
- 5.563" x 48", 36" above grade Galvanized Post
- Galvanized Stress Bracket (Patent Pending)
- Galvanized 18" ground sleeve
- Galvanized helix lock filler piece
- Galvanized 29" pipe extension for ground sleeve
- Tested with HDPE cover

#### 20 MPH Removable Bollard 6" (CIR HL2006 S20)

- Core-In ASTM F3016 S20 (20MPH) crash tested bollard system
- 6.625" x 48", 36" above grade Galvanized post
- Galvanized Stress Bracket (Patent Pending)
- Galvanized 24" ground sleeve
- Galvanized helix lock filler piece
- Galvanized 29" pipe extension for ground sleeve.
- Tested with HDPE cover

#### 10 MPH Fixed Bollard 5" (CIF 5560 S10)

- Core-In ASTM F3016 S10 (10MPH) crash-tested bollard system
- Galvanized Stress Bracket (Patent Pending)
- 5.565" x 60", 36" above grade Galvanized post
- Galvanized, welded rebar cage
- Tested with HDPE cover

#### 20 MPH Fixed Bollard 6" (CIF 6660 S20)

- Core-In ASTM F3016 S20 (20MPH) crash-tested bollard system
- Galvanized Stress Bracket (Patent Pending)
- 6.625" x 60", 36" above grade Galvanized post
- Galvanized, welded rebar cage
- Tested with HDPE cover

\*\*All systems available in Galvanized, Stainless Steel &  
Carbon Steel / Powder Coated Post Finishes

\*\*All systems tested with and without signage

# TRAFFICGUARD CORE-IN PROTECTION SYSTEM

**Protect your assets overnight with TrafficGuard® Core-In Protection Systems featuring patent pending foundation technology.**

- Bollard Warehouse, Inc. is the licensed manufacturer of TrafficGuard®, Inc. ASTM F3016 crash tested bollard line.
- Rapid installation in existing slabs of 3" or more.
- ASTM F3016 10 & 20 MPH fixed & removable bollard solutions.
- Removable units feature patented (US Patent 8,297,873) Helix Lock locking system.
- Removable units feature traffic rated sleeves.
- Fixed and Removable units available with signage.
- US Designed, Tested & Manufactured.

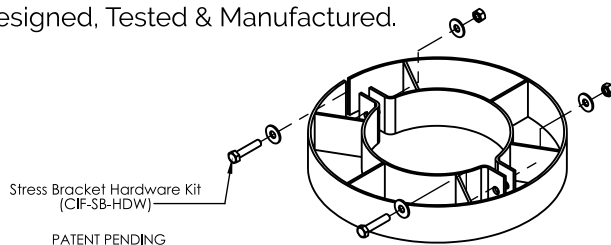

ASTM F3016-19  
S20 Fixed Post  
Bollard  
Assembly

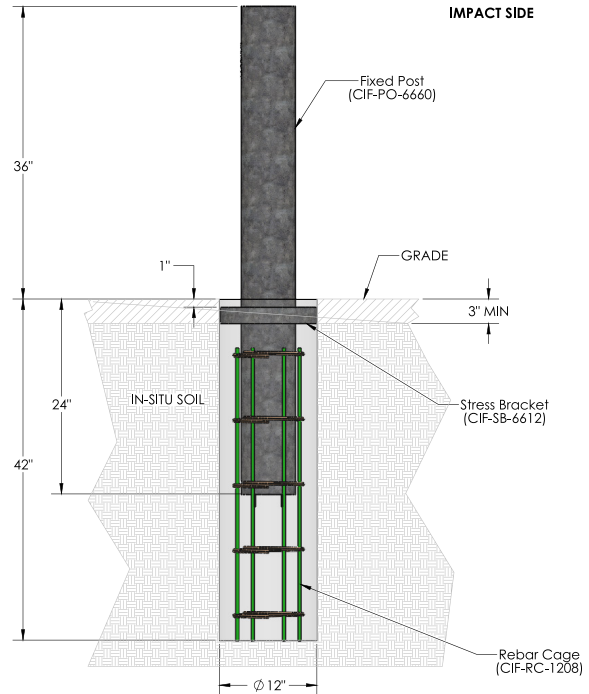
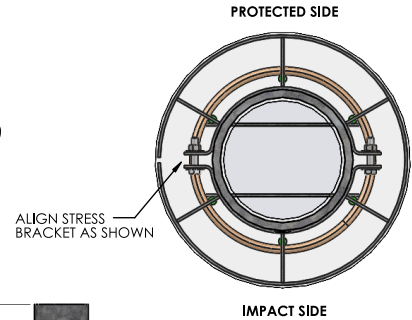

## FIXED BOLLARD OPTION

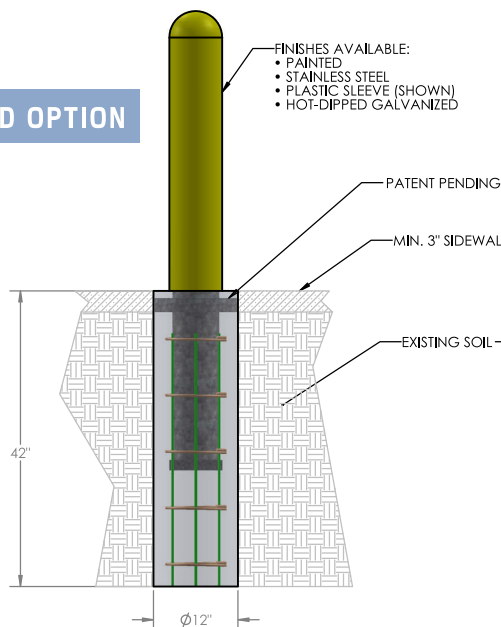

ASTM F3016 S20  
6 IN. Bollard

## REMOVABLE BOLLARD OPTION

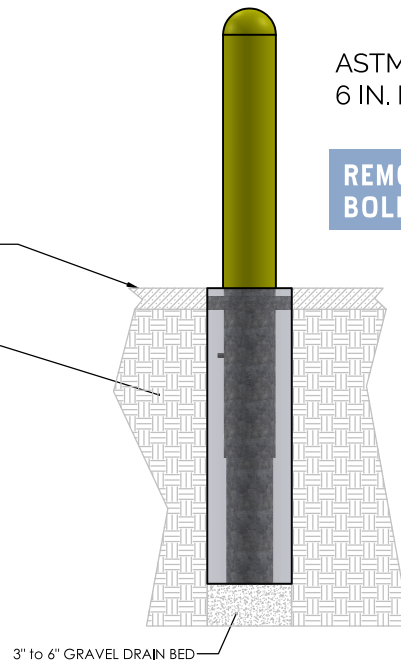

877-727-7347

[www.bollardwarehouse.com](http://www.bollardwarehouse.com)